

Minutes
Farmington High School Building Committee
Thursday, December 8, 2016
Community Meeting

A. Call to Order.

The meeting was called to order at 7:10 p.m.

B. Community Meeting.

Kaestle Boos Associates presented three (3) draft conceptual options to the public. A copy of their presentation is recorded with these minutes.

After the presentation, Marc Sklenka, Owner's Representative, fielded approximately 20 questions regarding phasing, educational programming, project timeline and overall cost and reimbursement.

C. Adjournment.

Upon a motion made and seconded the community meeting adjourned at 8:59 p.m.

Respectfully Submitted,



Kathryn Howroyd
Clerk of the Committee

Farmington High School Building Project

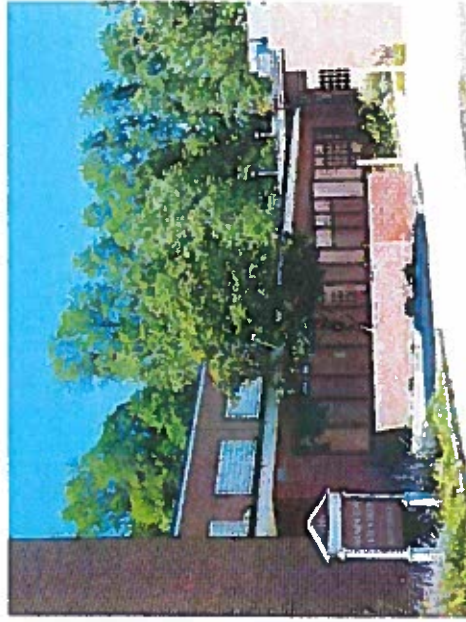

Farmington High School ~ 3 CONCEPTUAL OPTIONS

December 8, 2016 - PROGRESS

IDEAL LEARNING ENVIRONMENTS

The following design qualities emerged as essential elements of the ideal learning environment:

1. **Light** – open spaces, visibility, connection to the outdoors, and natural light;
 2. **Flexibility** – furniture and spaces that are multi-purpose, adaptable, moveable;
 3. **Independence** – space that fosters persistence, self-direction, choice and curiosity;
 4. **Collaboration** – places where students can interact and spontaneously work together, share ideas and work products
 5. **Reflection** – furniture and spaces that offer quiet places for contemplation and introspection;
 6. **Creativity** – a technology rich, imagination rich environment to foster a maker mindset;
 8. **Exhibition** – public places for work in progress and final products to be displayed and presented for feedback and critique; and
 9. **Joyous** – a school that is safe, warm, welcoming and nurturing of all learners
- These design qualities may be used to guide our thinking as we look forward into the future of our school facilities here in Farmington.

TYPICAL CLASSROOM CLUSTER

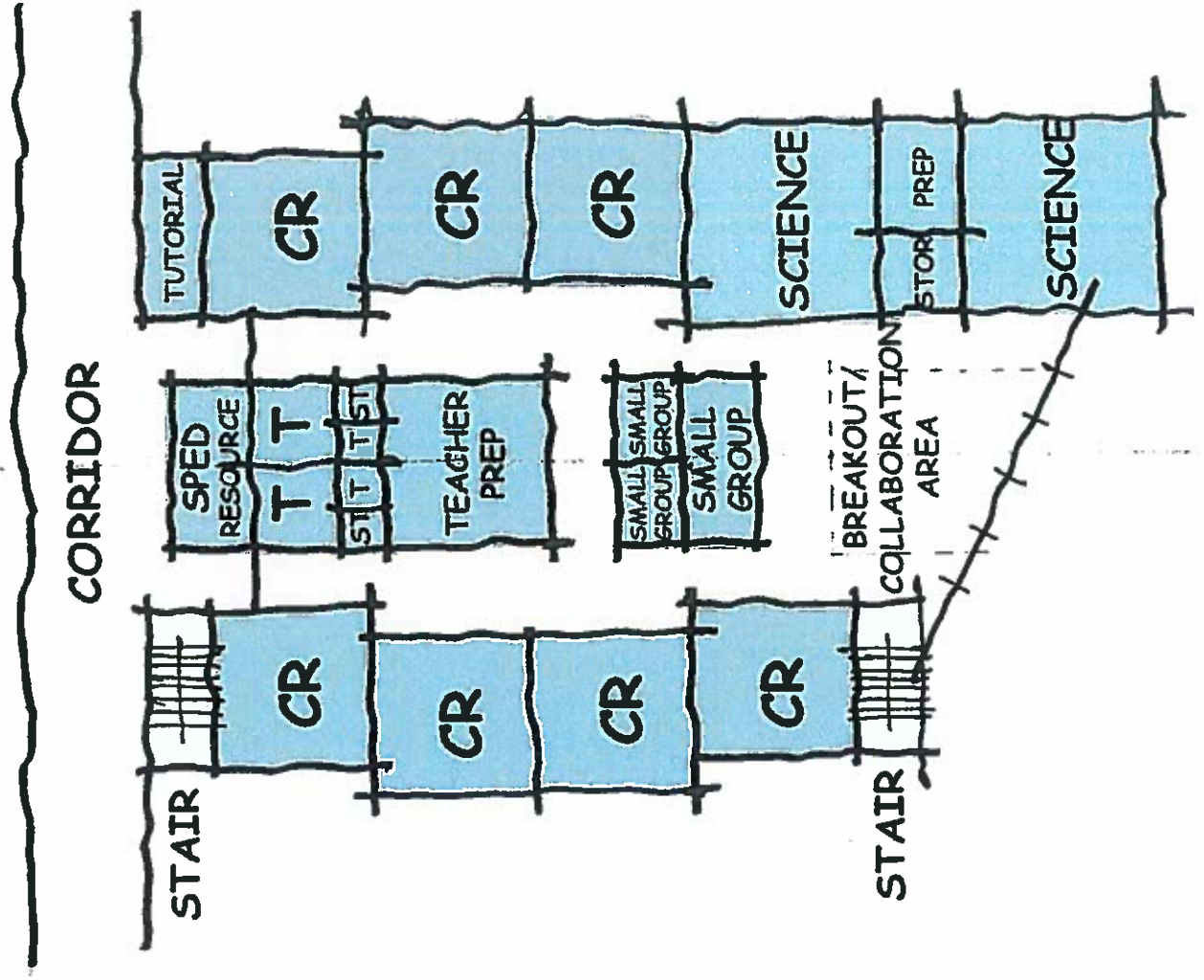

EXISTING BUILDING ANALYSIS

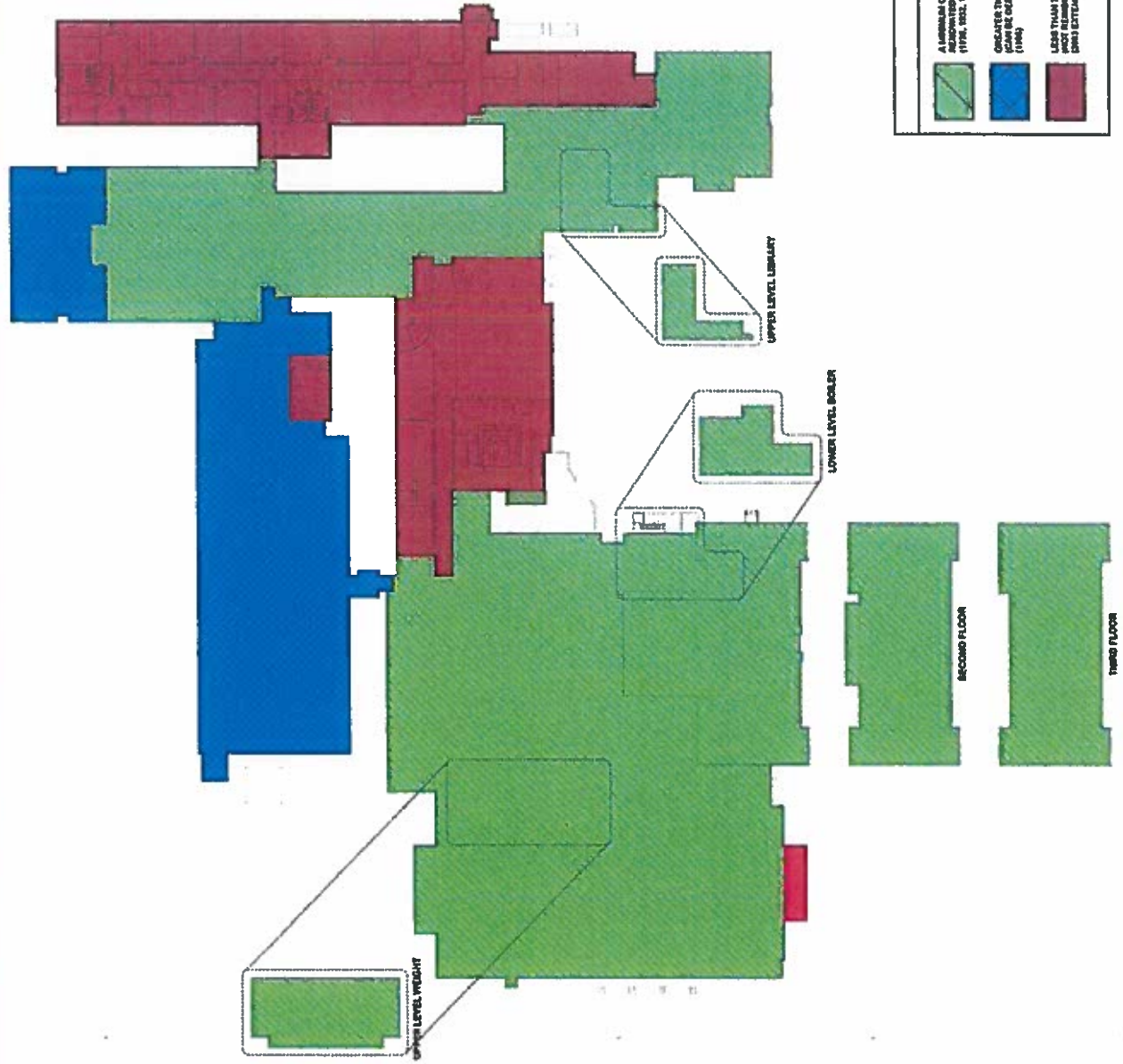

LEGEND

	A NUMBER OF THE EXISTING FACILITY IS BE ALTERNATE PARTS OF AT LEAST IN YEARS OLD (1976, 1952, 1964, 1957)	141,528 SF
	CONCRETE FRAME IN YEARS OLD (1964)	51,948 SF
	LOAD TRANS IN YEARS OLD WALLS RECONSTRUCTIBLE DOWNS EXTENSION / ALTERATIONS	43,428 SF
		TOTAL: 216,904 SF

OPTION A - SITE

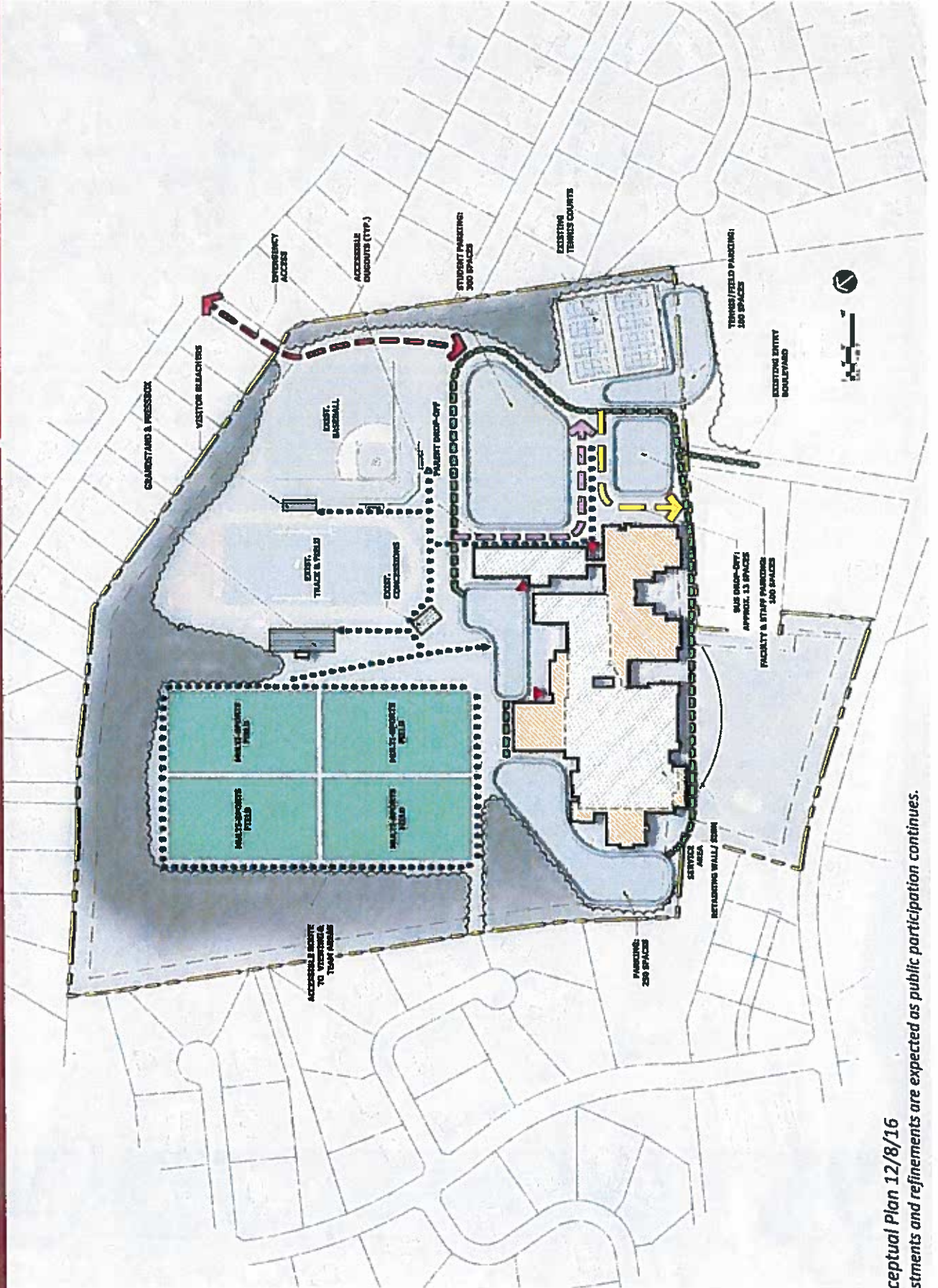

Conceptual Plan 12/8/16
Adjustments and refinements are expected as public participation continues.

OPTION A – MAIN LEVEL

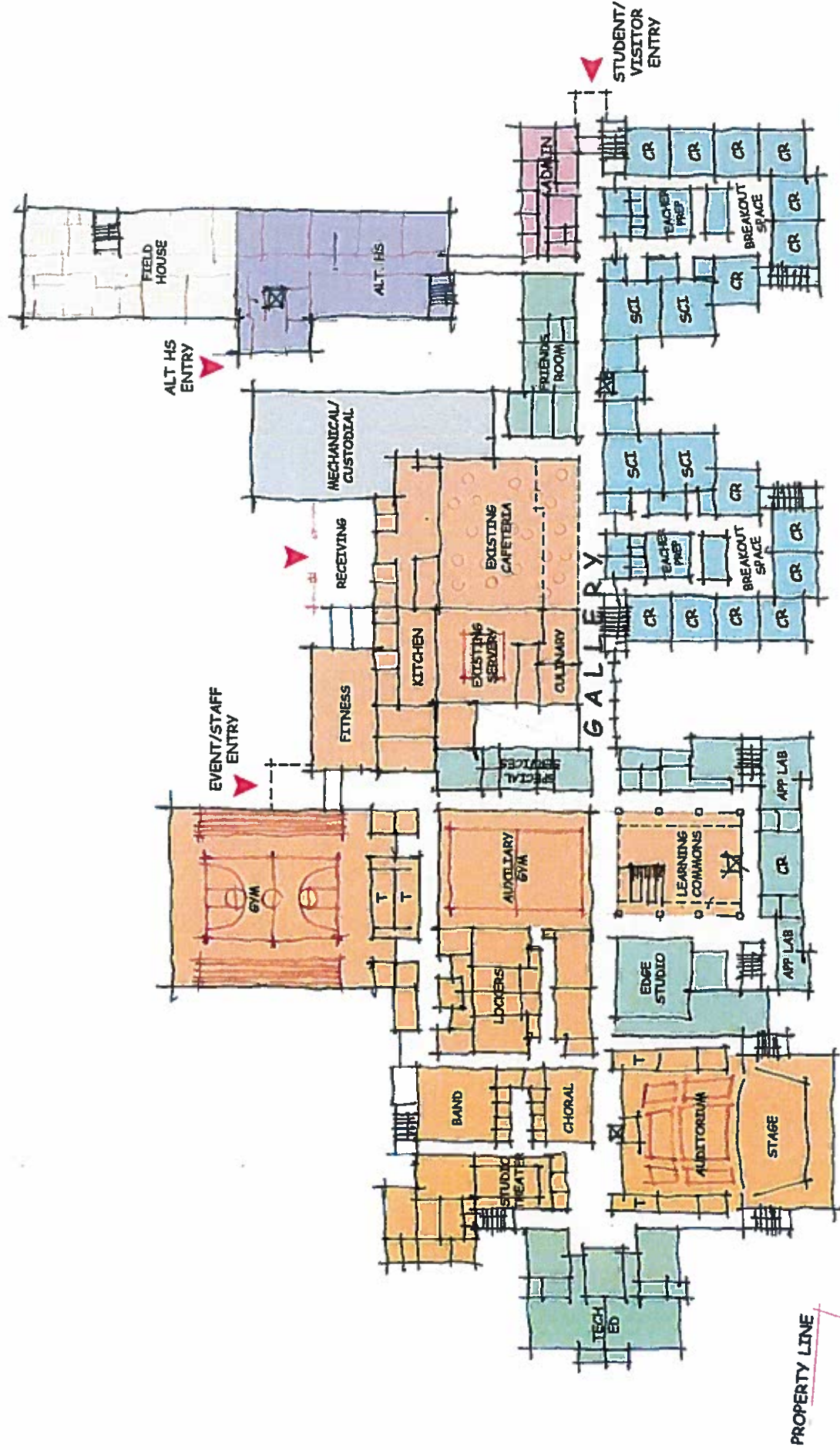

Conceptual Plan 12/8/16
Adjustments and refinements are expected as public participation continues.

OPTION A – MAIN LEVEL

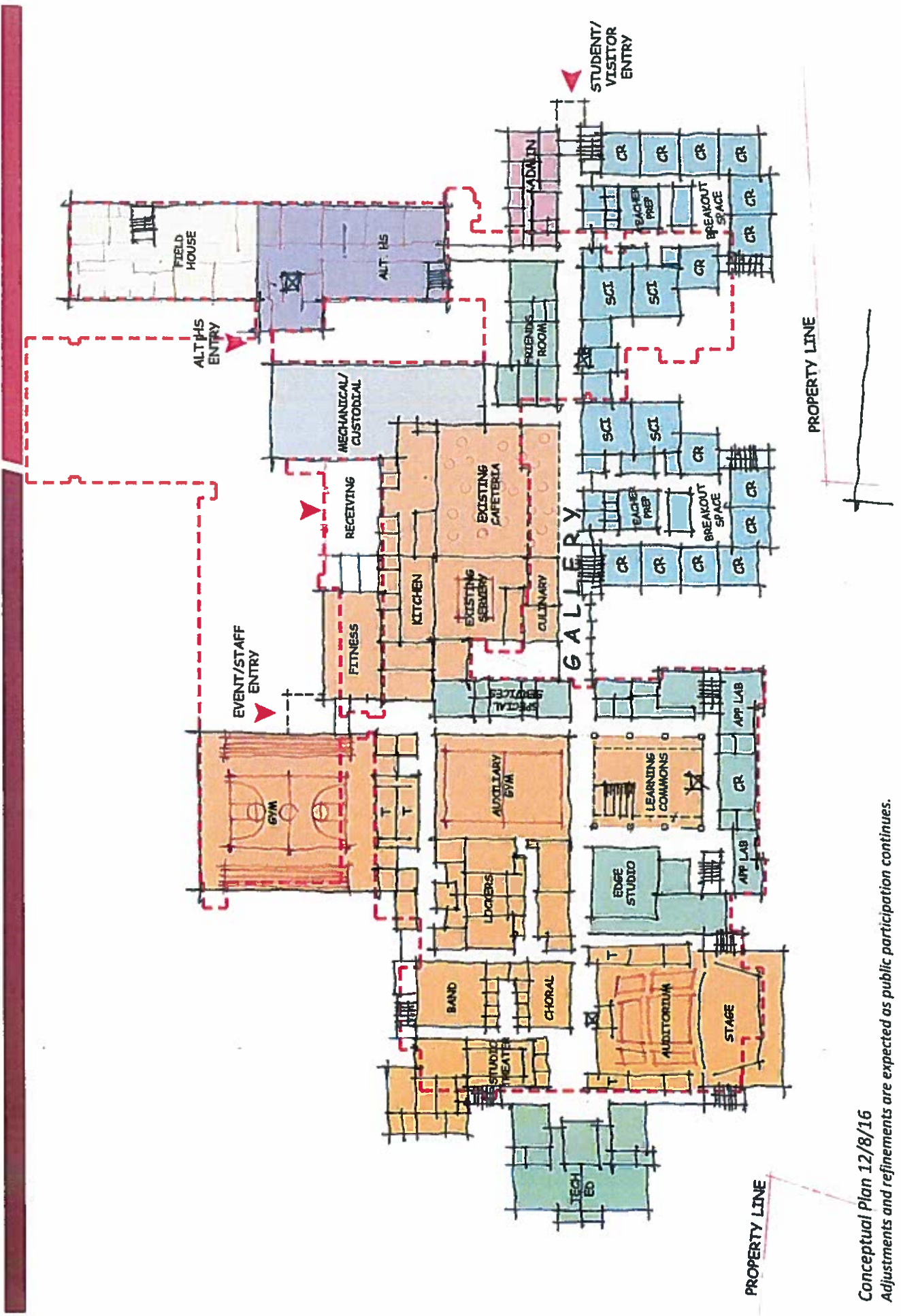

Conceptual Plan 12/8/16
Adjustments and refinements are expected as public participation continues.

OPTION A – SECOND LEVEL



Conceptual Plan 12/8/16
Adjustments and refinements are expected as public participation continues.

OPTION A – SECOND LEVEL

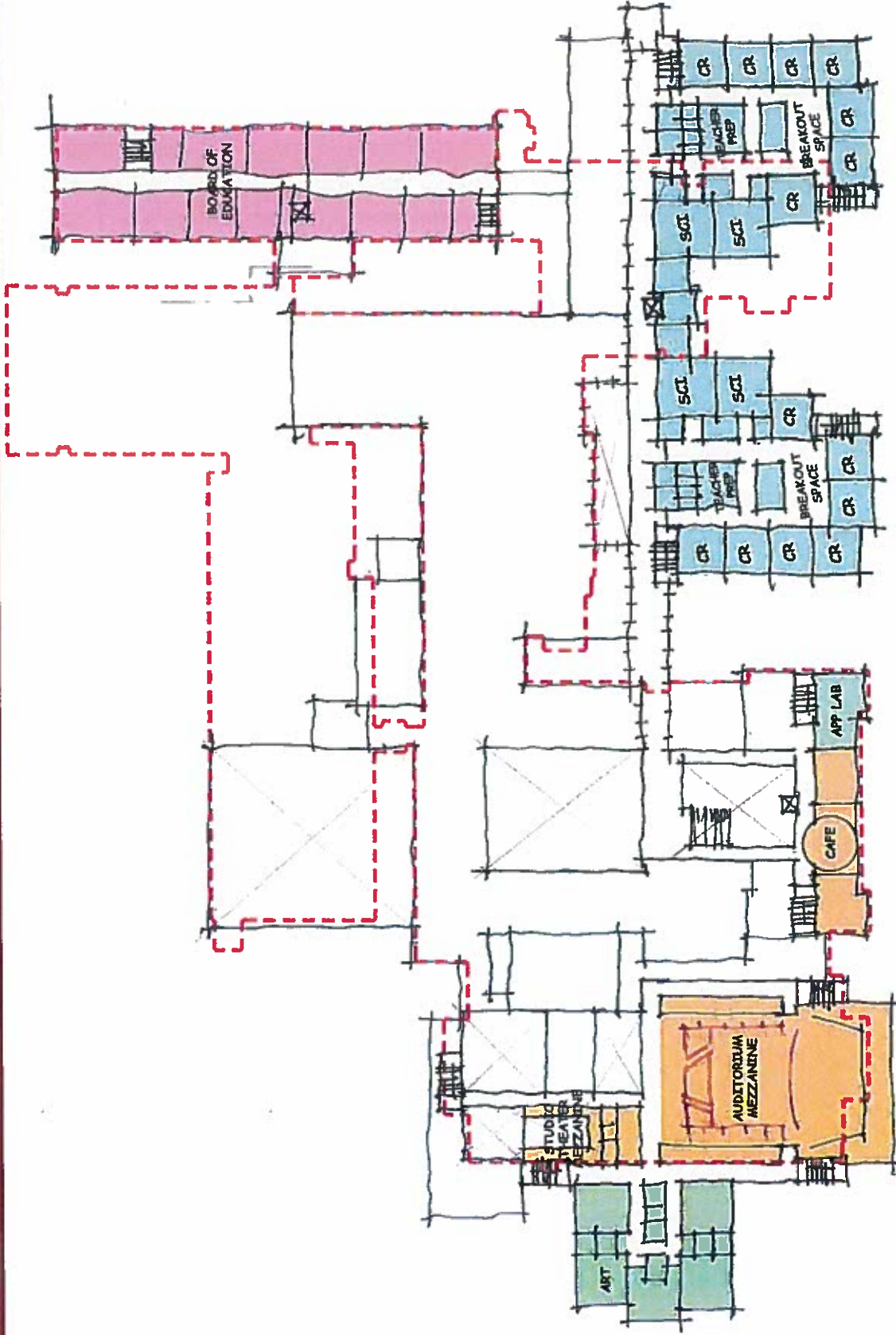

Conceptual Plan 12/8/16
Adjustments and refinements are expected as public participation continues.

OPTION A - THIRD LEVEL

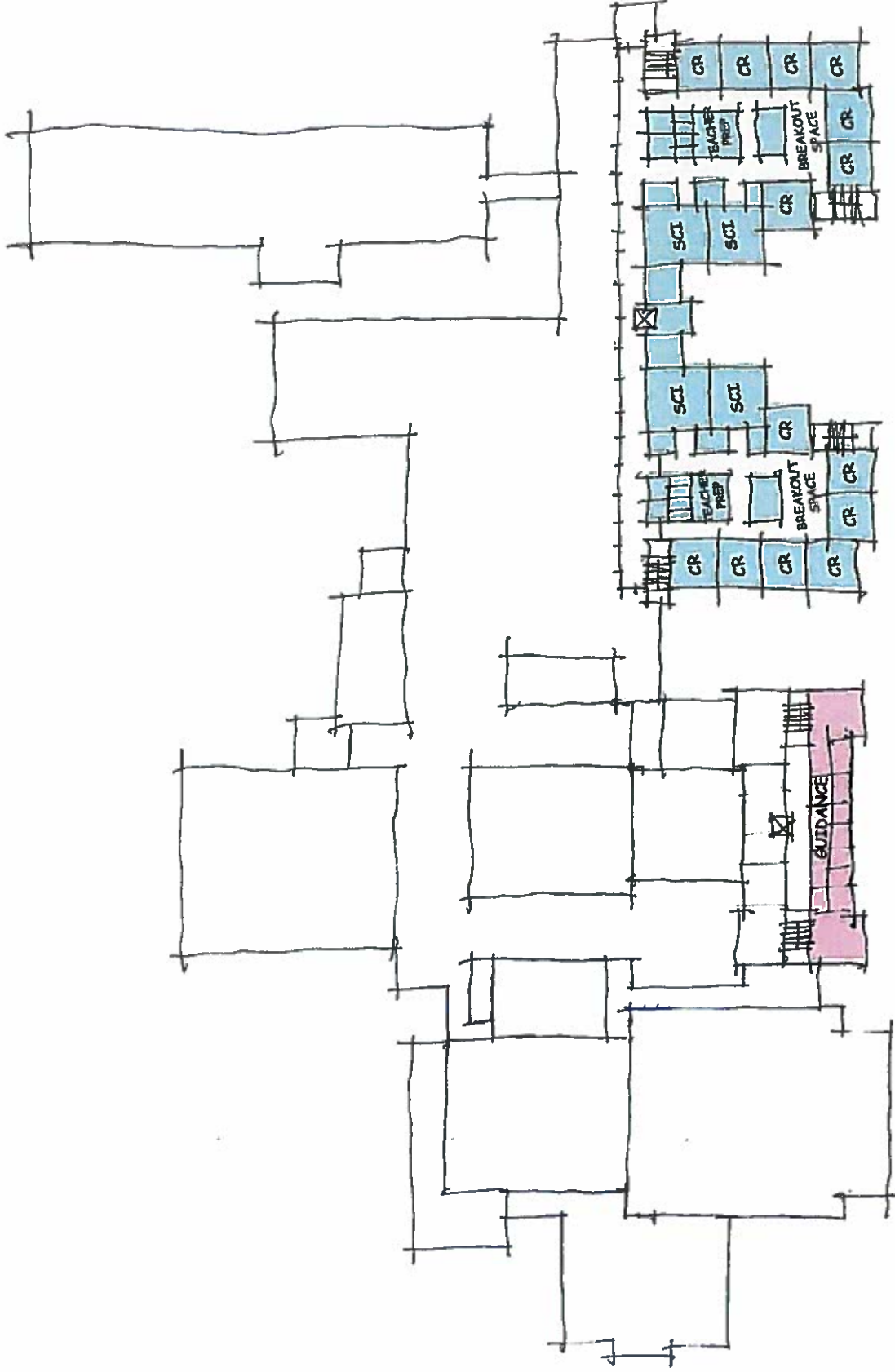

Conceptual Plan 12/8/16
Adjustments and refinements are expected as public participation continues.

OPTION A – THIRD LEVEL

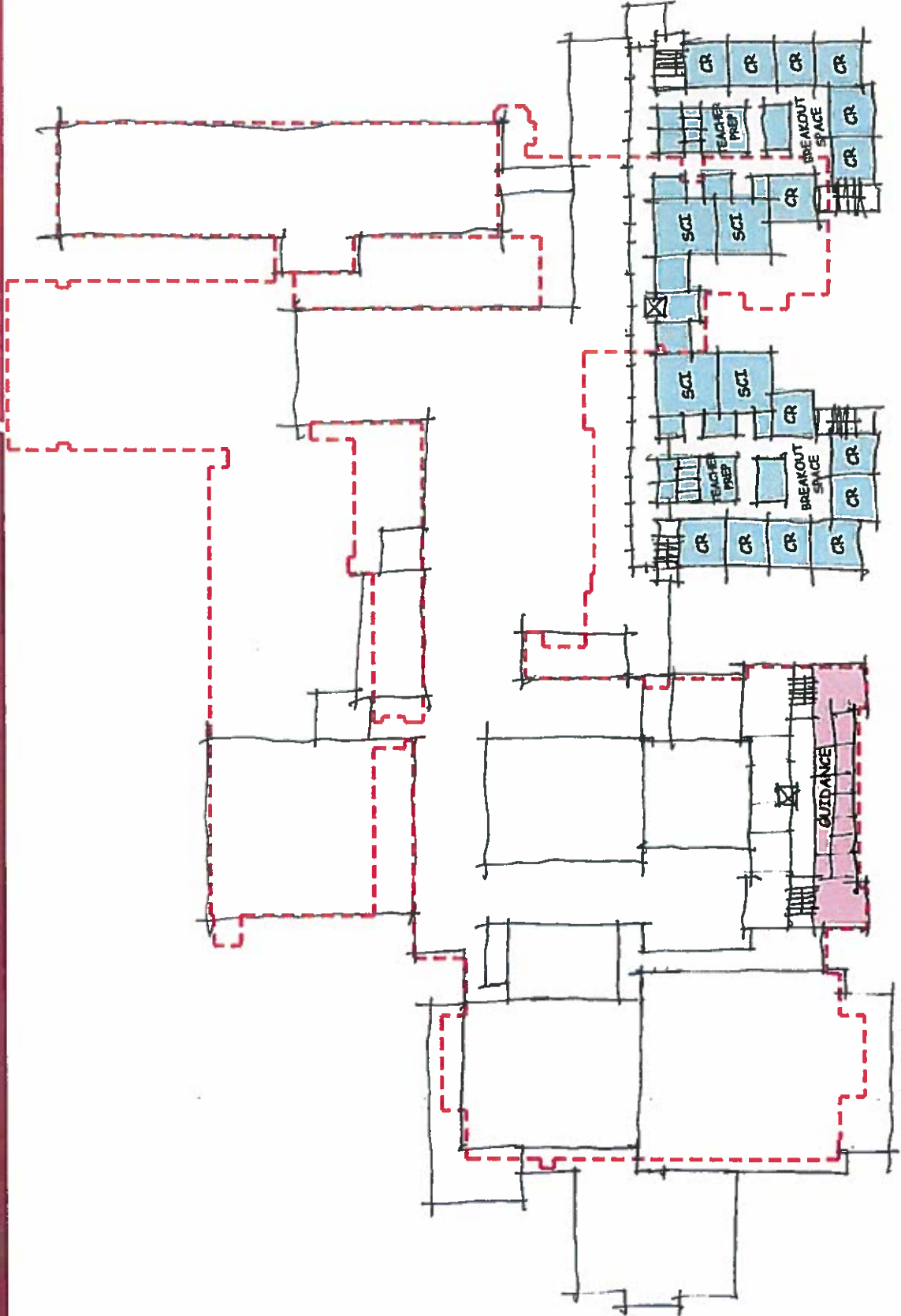

OPTION B – MAIN LEVEL

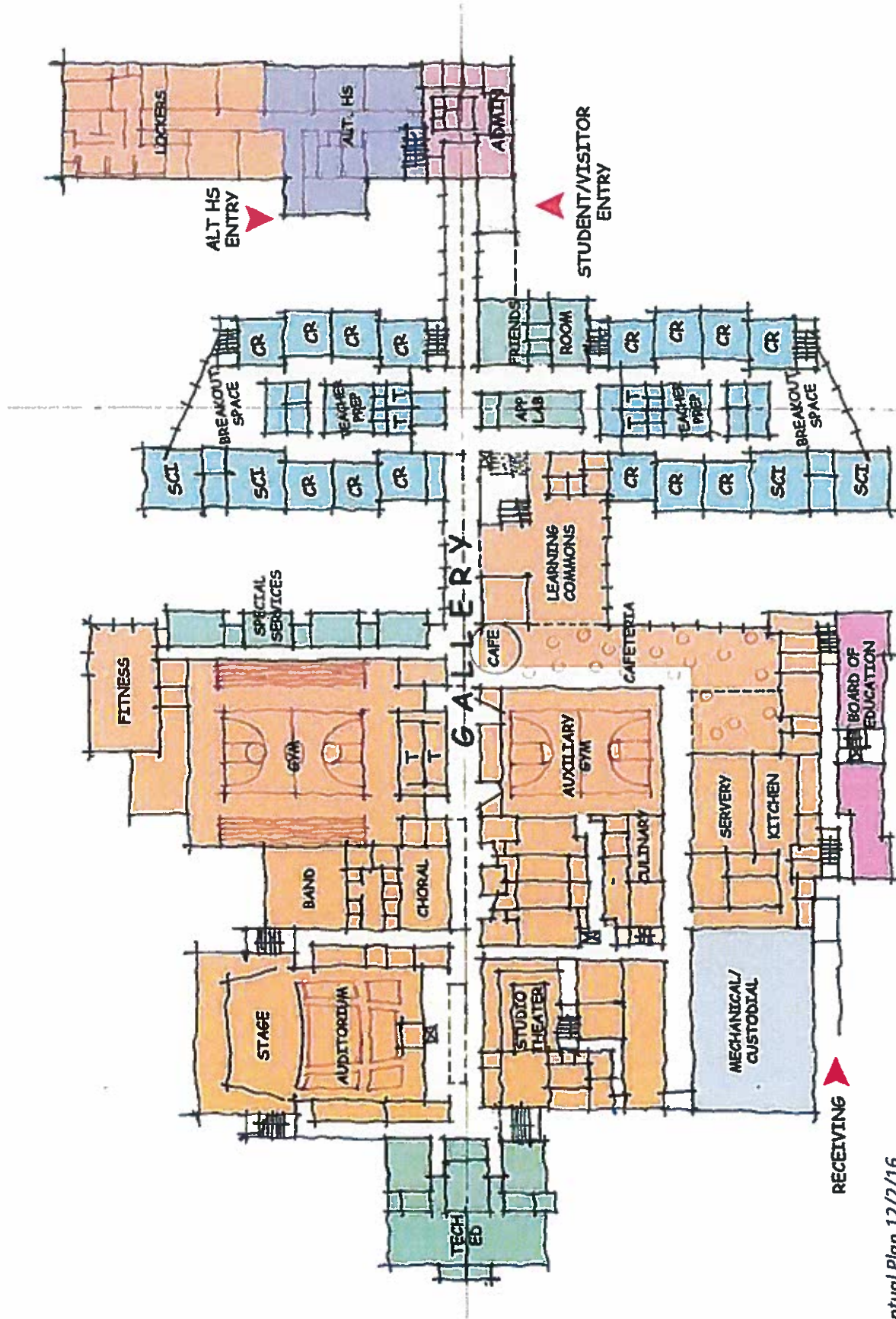

RECEIVING

Conceptual Plan 12/2/16
Adjustments and refinements are expected
as public participation continues.

OPTION B - SECOND LEVEL

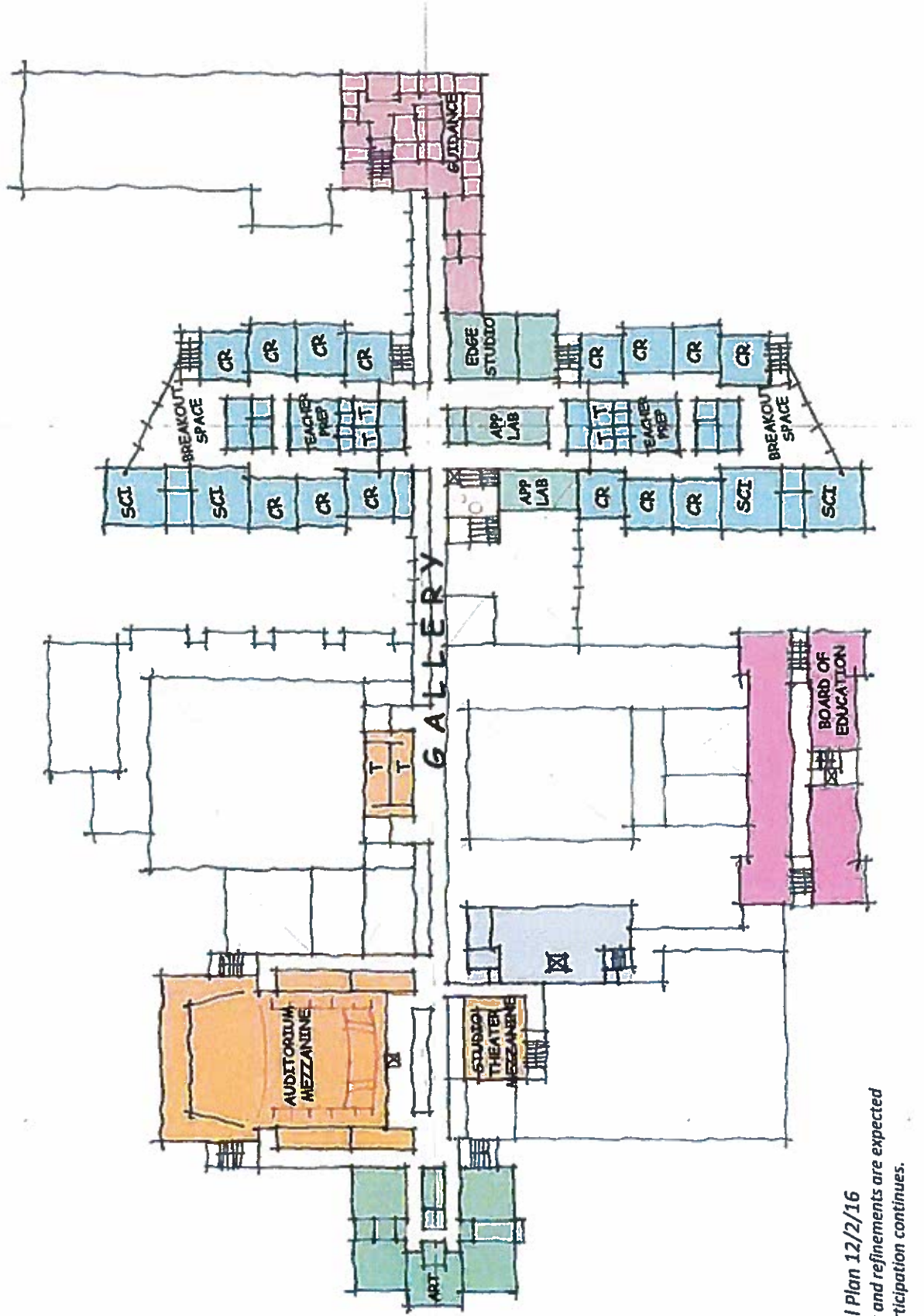

*Conceptual Plan 12/2/16
Adjustments and refinements are expected
as public participation continues.*

OPTION B - THIRD LEVEL

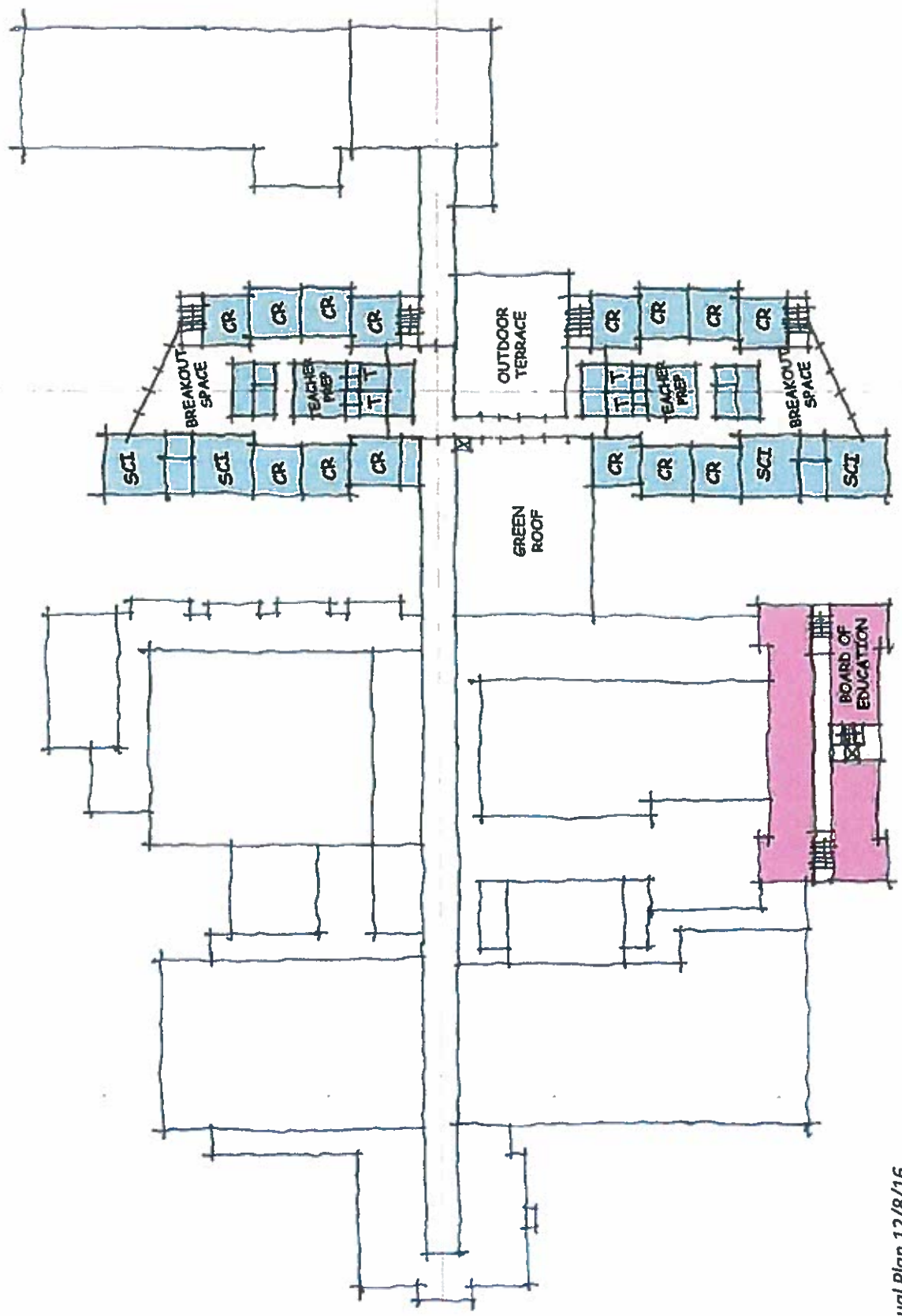

Conceptual Plan 12/8/16
Adjustments and refinements are expected as public participation continues.

OPTION C - LOWER LEVEL

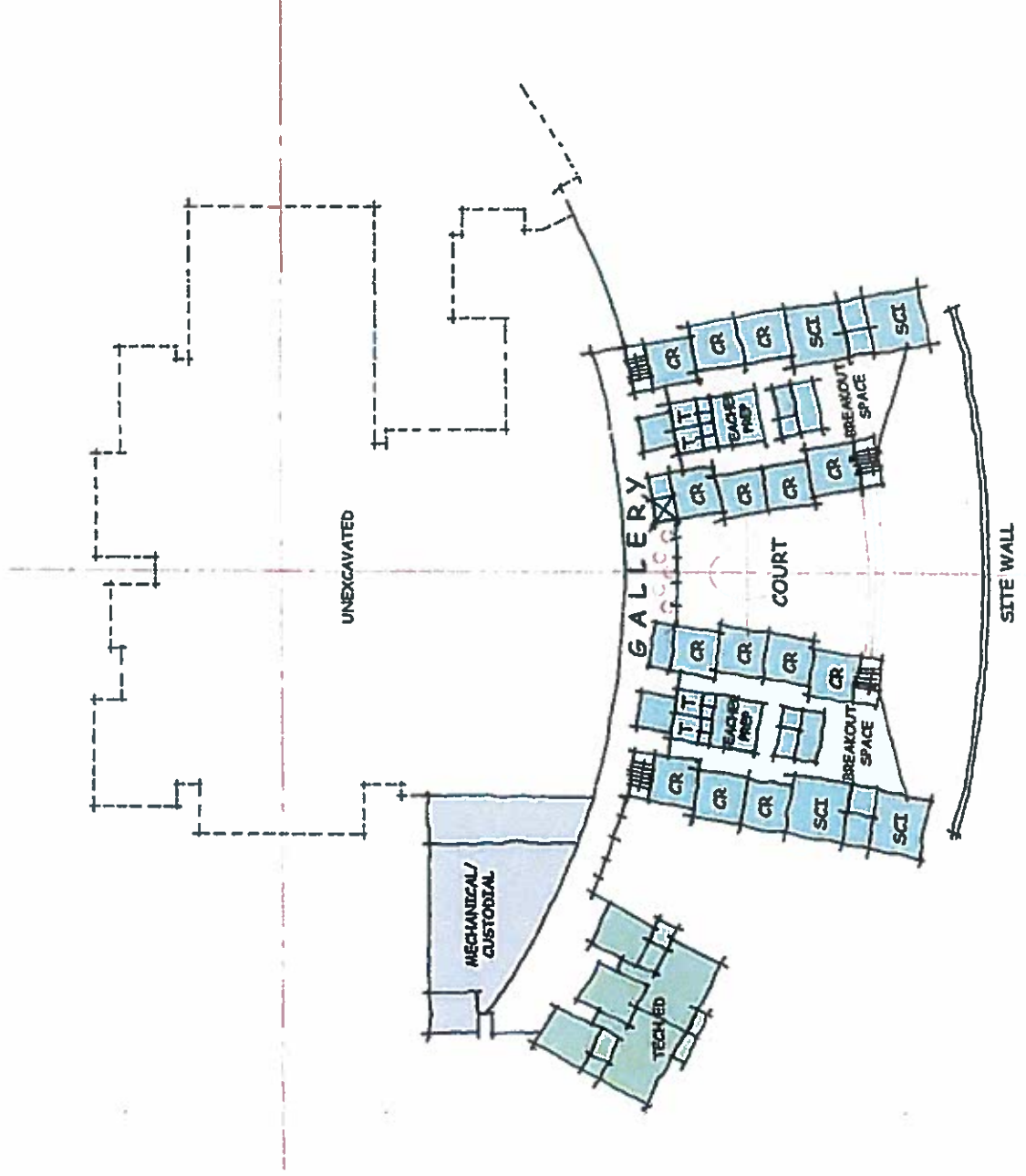

Conceptual Plan 12/8/16
Adjustments and refinements are expected as public participation continues.

OPTION C – MAIN LEVEL

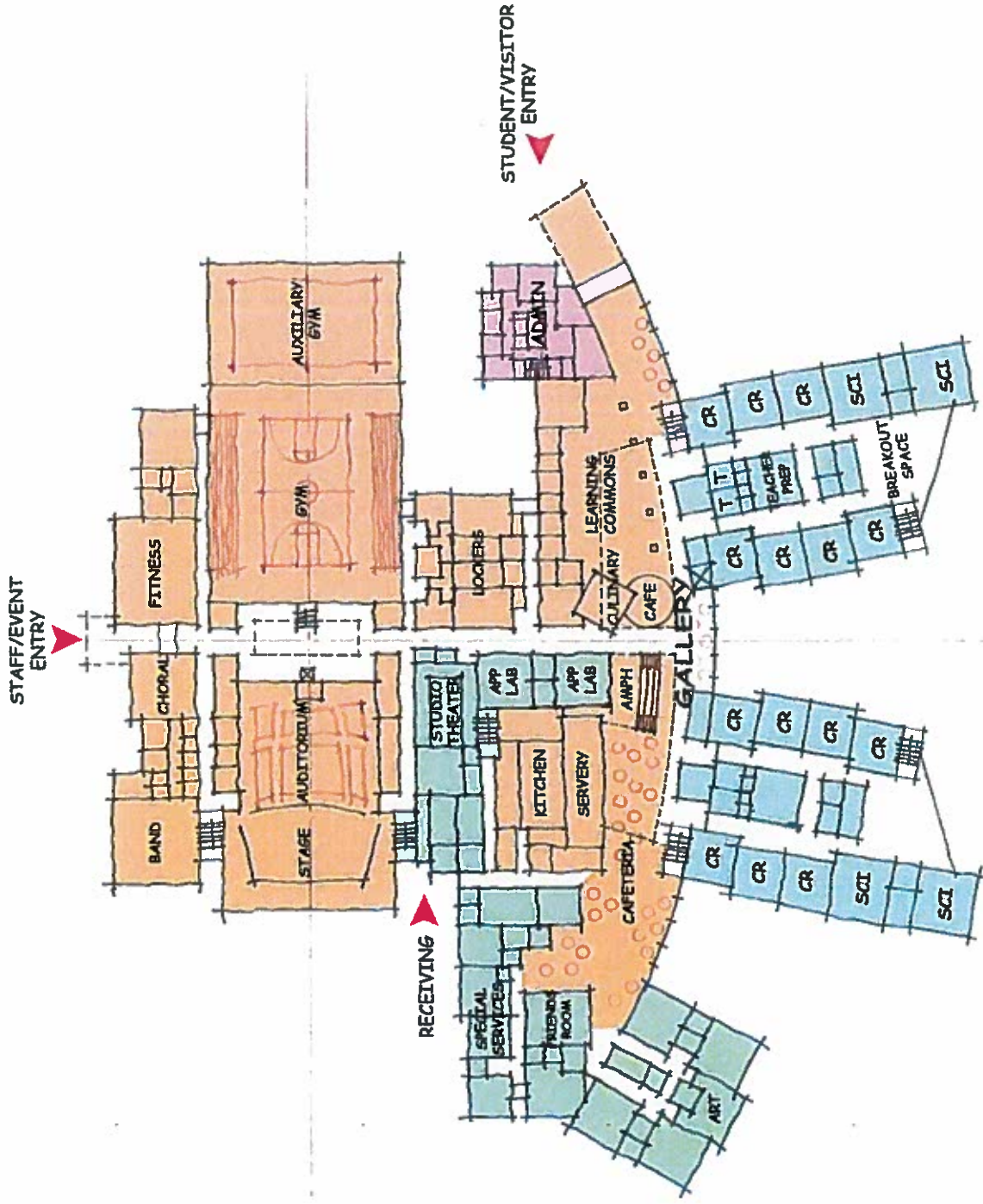

Conceptual Plan 12/8/16
Adjustments and refinements are expected as public participation continues.

OPTION C - UPPER LEVEL

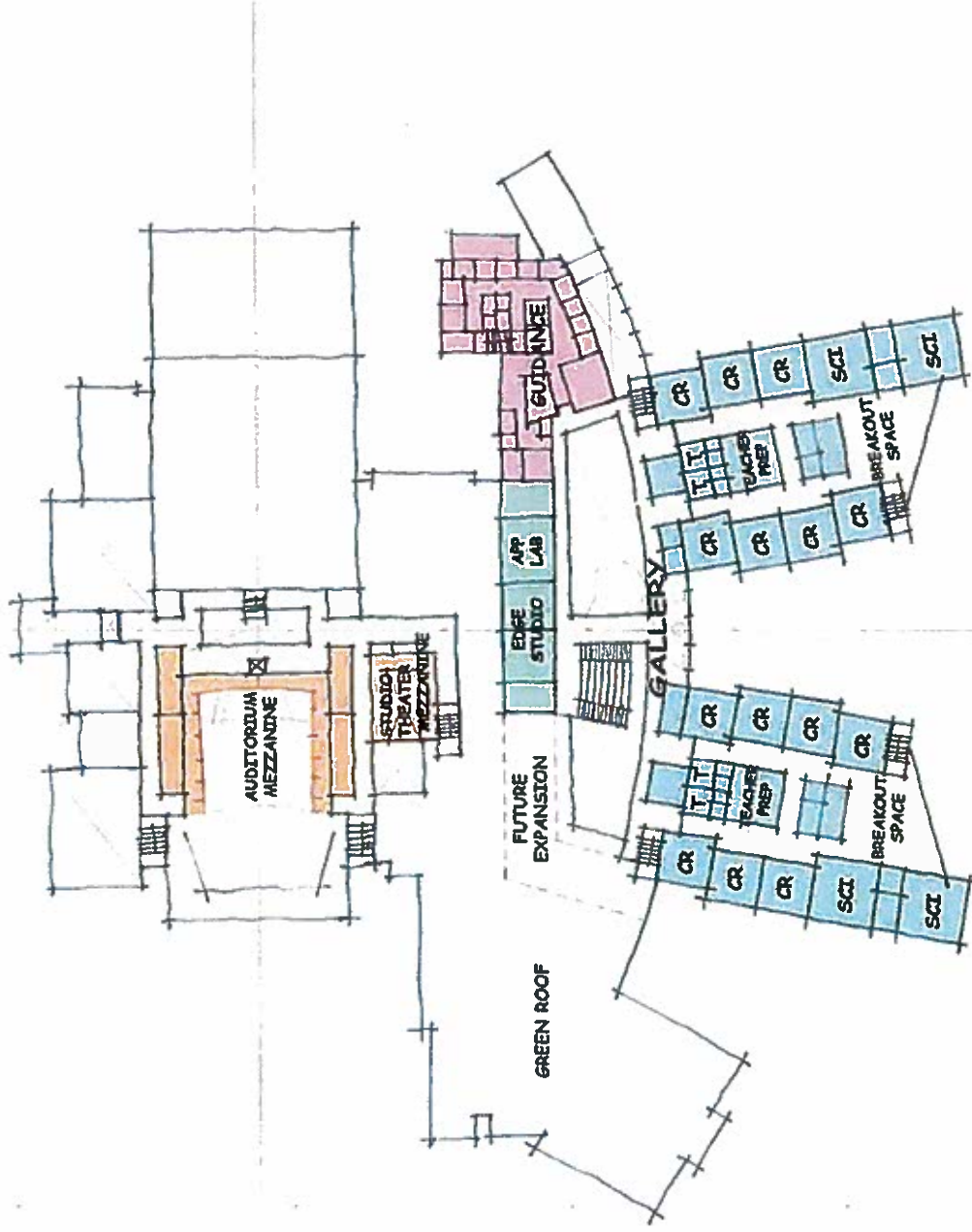

Conceptual Plan 12/8/16
Adjustments and refinements are expected as public participation continues.

AMPHITHEATER / COLLABORATION SPACE

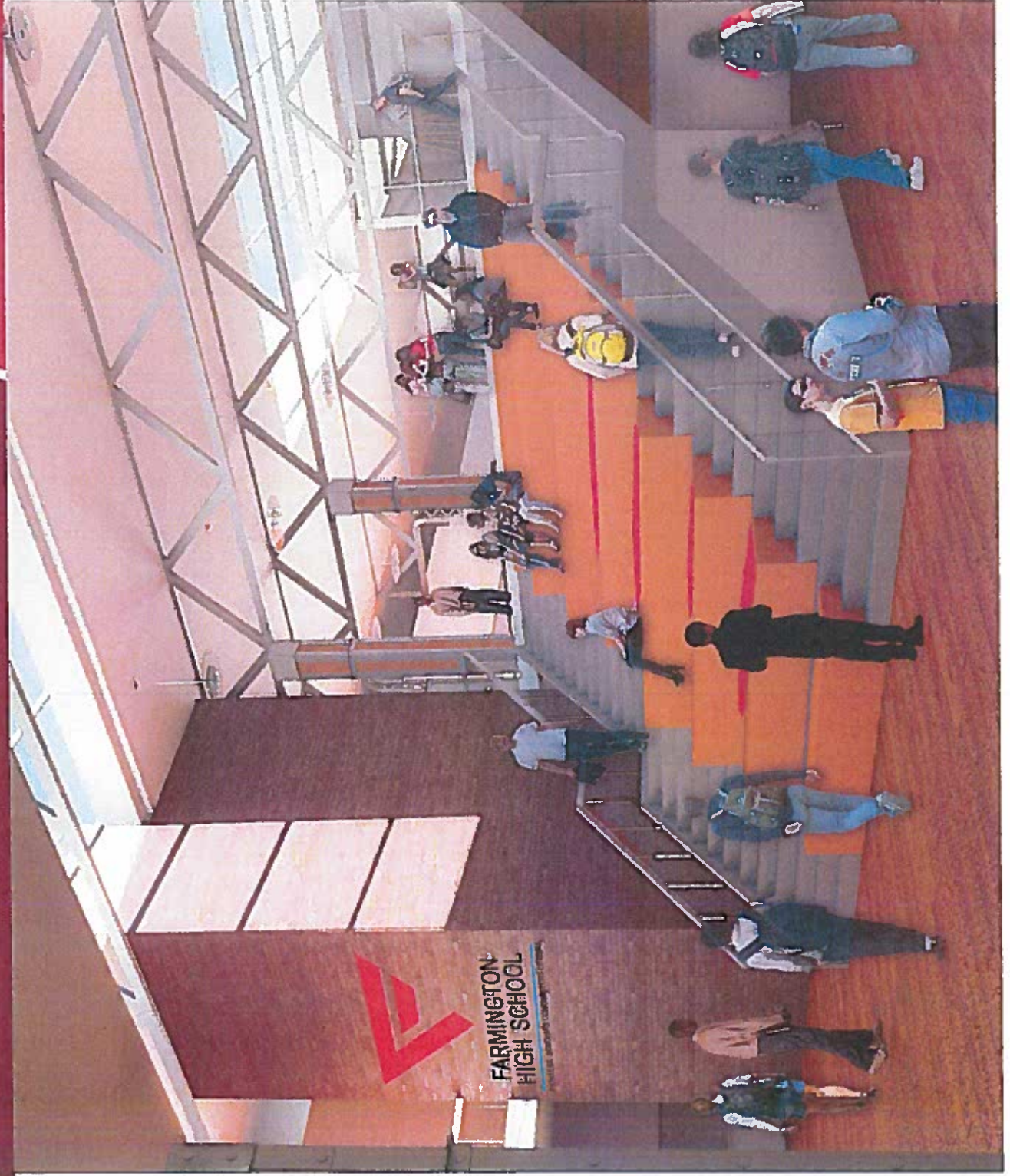

Farmington High School Building Project

Q & A

